



BEARWOOD
LAKES

A DAY TO REMEMBER

A DAY TO REMEMBER

Planning your special day can be easier than you imagine. It is important to have the right venue, plenty of flexibility with a friendly and experienced team to welcome you and your guests.

Bearwood Lakes brings together everything you need in one outstanding location. Luxurious facilities surrounded by 200 acres of countryside and woodland. Classical style with modern comfort.





PUTTING ON A SHOW

From the smile that greets you when you arrive to that last drink before the evening ends, every moment at Bearwood Lakes will be special. Our creative team will ensure that your day is planned to perfection.

The dining and reception areas open on to our full length balcony offering beautiful panoramic views. After your dinner relax with a drink on our full length balcony which offers beautiful panoramic views. Then take to the dance floor to continue your celebrations.





DINE IN STYLE

We offer an extensive A La Carte menu and invite you to personalise your choices with the help of our experienced chefs.

The beautifully decorated restaurant facilities comfortably seat up to 110 guests or cater for up to 150 guests 'buffet style'.

We are dedicated to providing a professional quality service. Our team are on hand to assist with organising your entertainment, flowers, photography, video, car and chauffeur hire and wedding cake, ensuring...

...a day to remember.





ROOM PLAN

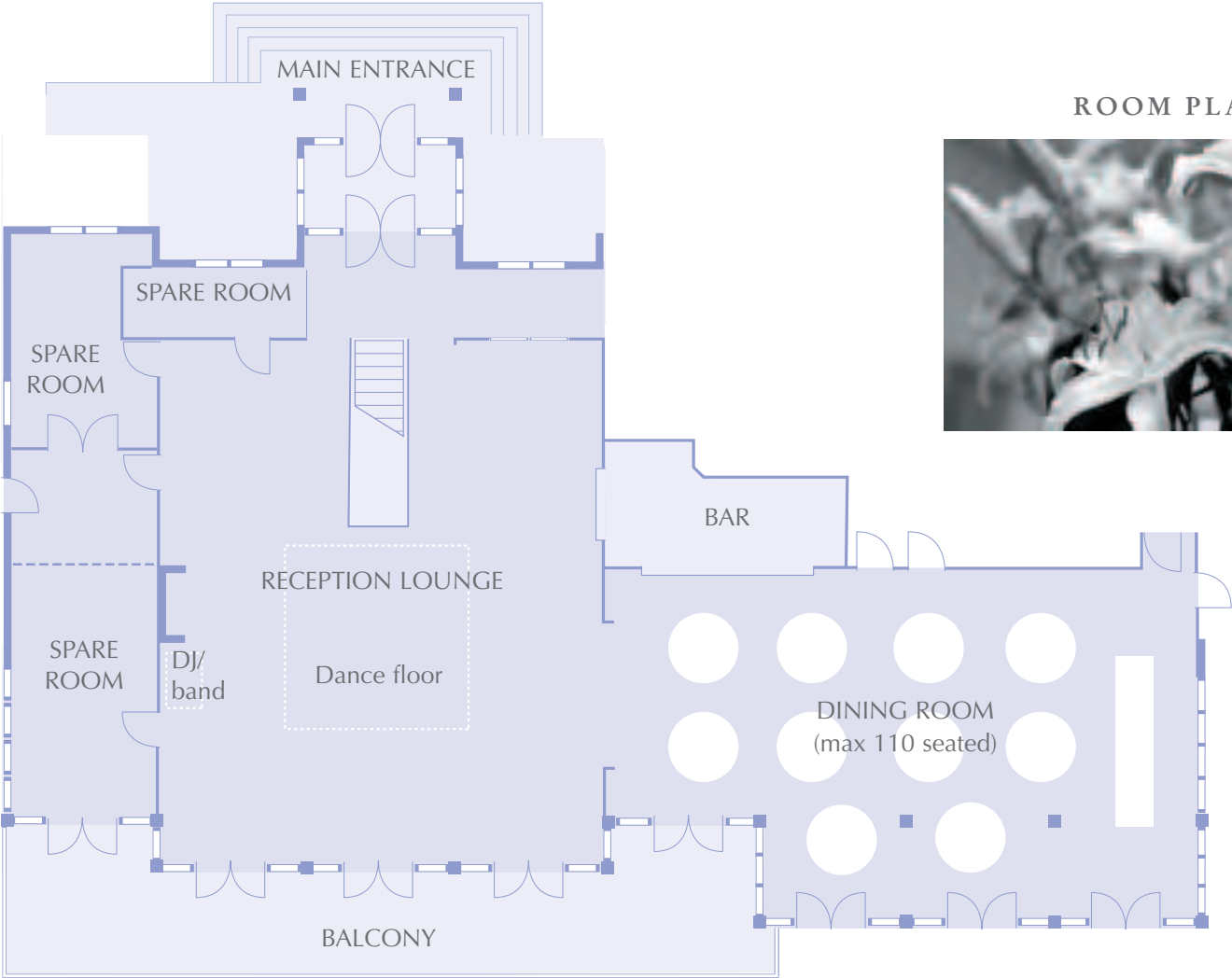

DIRECTIONS TO BEARWOOD LAKES

FROM THE M3

Exit Junction 3 and take A322 to Bracknell. Follow signs through Bracknell towards M4 and Reading. Join the A329(M) towards Reading and exit at the Winnersh Triangle (also sign posted Park & Ride, Multiplex Cinema and Woodley). Then follow directions as *FROM THE M4, as shown on the right.

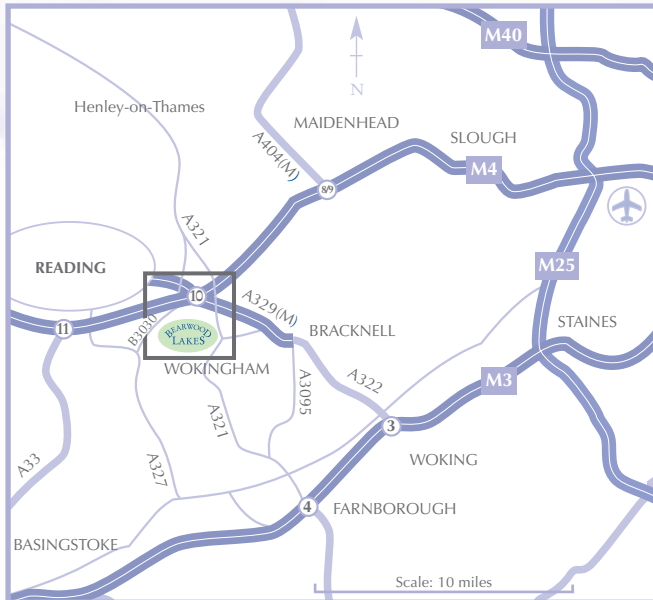

FROM THE M4

Exit at Junction 10 and take A329(M) towards Reading. Take first exit at Winnersh Triangle (also sign-posted Park & Ride, Multiplex Cinema and Woodley).

* Follow signs towards Wokingham on A329. Turn right at main crossroads and traffic lights by Texaco garage. Turn left at mini roundabout into Bearwood Road. Pass Walter Arms Pub and Church on left. Bearwood Lakes is 300 yards on right.

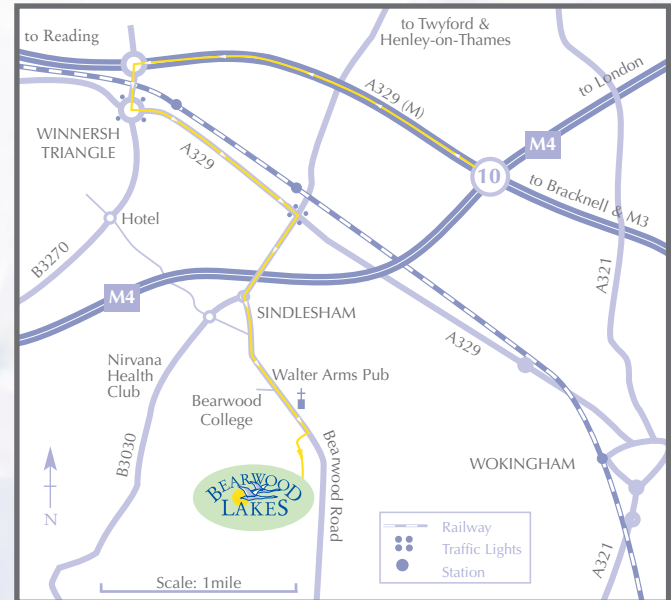



BEARWOOD LAKES GOLF CLUB PLC

BEARWOOD ROAD SINDLESHAM NEAR WOKINGHAM BERKSHIRE RG41 4SJ

t: 0118 979 7900 f: 0118 979 2911 w: www.bearwoodlakes.co.uk e: golf@bearwoodlakes.co.uk